



COUNTY OF WETASKIWIN NO. 10

Strong Proactive Leadership • Safe Progressive Communities

Phone 780-352-3321 Toll Free 1 (800) 661-4125
www.county.wetaskiwin.ab.ca

DEVELOPMENT PERMITS

TAKE NOTICE THAT THE FOLLOWING DEVELOPMENT PERMIT(S) FOR THE PROPOSED USE LISTED BELOW HAVE BEEN ISSUED IN ACCORDANCE WITH BY-LAW 2017/48, LAND USE BYLAW OF THE COUNTY OF WETASKIWIN NO. 10.

Application No. D20/002

Custom Grain Drying Business: SE-28-46-23-W4 Plan 2820LZ. This is a discretionary use as specified by Section 10.1.3 and as determined under Section 3.7 of Land Use Bylaw 2017/48.

Any person wishing to review the above permit(s) may do so at the County Office during normal business hours or request by email to wpermits@county10.ca.

IN ACCORDANCE WITH SECTION 686 OF THE MUNICIPAL GOVERNMENT ACT, ANY PERSONS CLAIMING TO BE AFFECTED BY THIS DECISION MAY SERVE WRITTEN NOTICE OF APPEAL, ALONG WITH PRESCRIBED FEE OF \$150.00 TO:

ROD HAWKEN, SECRETARY TO THE DEVELOPMENT APPEAL BOARD
COUNTY OF WETASKIWIN NO. 10 P.O. BOX 6960 WETASKIWIN, ALBERTA T9A 2G5
WITHIN TWENTY ONE DAYS OF THE FIRST DATE OF THIS NOTICE.

NOTICE OF PUBLIC HEARING

TAKE NOTICE that the Council of the County of Wetaskiwin No. 10 has been asked to adopt an Area Structure Plan within **NW-8-44-22-W4M**, for the Malmo Mission Covenant Church on the following land which is located at the intersection of Township Road 442 and Highway 822, as shown on the accompanying map.

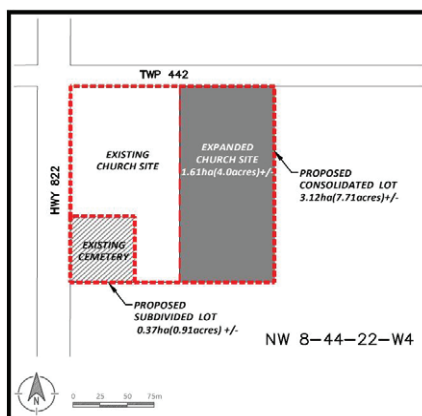

Before considering the adoption of the Area Structure Plan, Council will hold a public hearing at which any person claiming to be affected by the proposed Area Structure Plan may ask questions or make their views known.

The hearing will be held in the Council Chambers of the County of Wetaskiwin Administration Building located 2.4 kilometres west of Wetaskiwin on Highway 13, at 9:15 a.m. on Thursday, March 12, 2020.

Written submissions will be accepted up to the time of the hearing and should be addressed to

the undersigned at the County Administration Building. As per the Municipal Government Act, any person affected, has the right to petition this proposal.

A copy of the proposed Plan may be picked up at the County of Wetaskiwin Administration Building or by contacting the Planning and Economic Development Department at wpermits@county10.ca

DAVID BLADES, A. Sc. T., LGA

Director of Planning & Economic Development, County of Wetaskiwin No. 10

RECREATION ZONE 2 ELECTIONS OF THE RECREATION COMMITTEE & GRANT MEETING

Wednesday, March 18, 2020 at 6:30 p.m. at Lone Ridge Community Hall

Are you interested in becoming a Committee Member of the Zone 2 Recreation Committee? If you would like to get more involved in Zone 2 and the process, please attend at 6:30 p.m. and advise you would like to be on the Committee.

At 7 p.m. applications will be presented to the new Committee. Any group wanting an applications form, they are available on the County of Wetaskiwin website at www.county.wetaskiwin.ab.ca

Please have all the required information attached to the application, as all the applications have to be handed into the County by the end of March.

If you have any further questions please contact Geoff Lynch at glynch@county10.ca

OPPORTUNITY FOR TEMPORARY EMPLOYMENT

Beaver Trapper • Posting #2020/02

The Position: The County of Wetaskiwin is seeking a seasonal temporary position of Beaver Trapper. This position works up to 40 hours per week Monday to Friday, from Spring break-up (April 15) to approximately November 15, 2020.

Reporting to the Director of Agricultural Services, you will be responsible for the safe and efficient removal of beaver and beaver dams on County land, Crown land and occasionally private land. This will include setting beaver traps, trapping beavers, breaching of beaver dams through blasting and removal of debris.

Required Skills:

- A valid Class 5 Drivers License
- Time management skills
- The ability to work alone with flexible hours
- Resident Trapper
- Registered Trapper with Fish and Wildlife
- Must have the ability to obtain an Explosives Permit for Beaver Dam
- must have a cellular phone
- must be able to meet the physical demands of the position
- demonstrate excellent interpersonal skills.

The County of Wetaskiwin offers a strong corporate culture and salary is in accordance with the International Union of Operating Engineers Collective Agreement with a starting wage of \$21.22 per hour to \$24.79 per hour, depending on qualifications.

Qualified candidates are asked to submit their resume by 12:00 Noon, Friday March 6, 2020 to:

Barb Wolter, Executive Assistant
County of Wetaskiwin No. 10 Box 6960, Wetaskiwin, AB, T9A 2G5
(780) 352-3486 (fax) / (780) 352-3321 (phone)
Email: bwolter@county10.ca Online: www.county.wetaskiwin.ab.ca

The County of Wetaskiwin would like to thank all applicants for their interest, however only the candidates selected for interviews will be contacted.