



COUNTY OF WETASKIWIN No.10
 Strong Proactive Leadership • Safe Progressive Communities

Phone 780-352-3321 Toll Free 1 (800) 661-4125
 www.county.wetaskiwin.ab.ca



MULHURST BAY LAGOON
HOURS DURING THE 2015 HOLIDAY SEASON

Be advised that the Mulhurst Bay Lagoon Hours during the 2015 Holiday Season are as follows:

Thursday, December 24, 2015	9:00 a.m. to 1:00 p.m.
Friday, December 25, 2015	Closed
Saturday, December 26, 2015	9:00 a.m. to 5:00 p.m.
Monday, December 28, 2015	9:00 a.m. to 5:00 p.m.

Friday, January 1, 2016 Closed

Regular Business Hours for all other days.

If an emergency arises during these times, please contact Garry Ellison, Utilities Foreman, at 780-387-6317.

NOTICE OF PUBLIC HEARING

County of Wetaskiwin No. 10
 Notice of proposed change in land use classification

TAKE NOTICE that the Council of the County of Wetaskiwin No. 10 has received an application to amend its Land Use By-Law by rezoning part of the following land, as shown on accompanying map, from **Agricultural** to **Recreational** Districting:

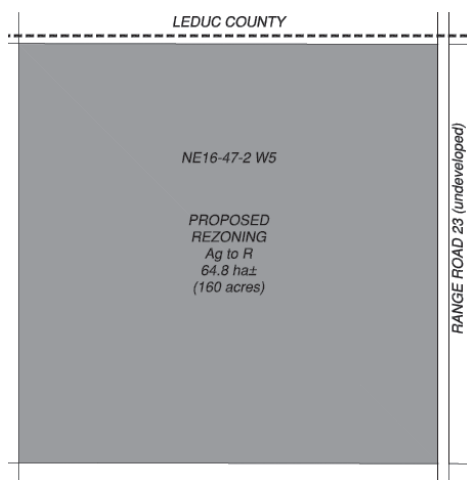

NE 16-47-2-W5M

If the rezoning is approved, the applicant intends to bring the existing campground into compliance with the County's Land Use By-Law. A copy of the Recreational District outlining permitted and discretionary uses can be obtained from the County Office.

Before proceeding further with the proposal, Council will hold a Public Hearing at which any person claiming to be affected by the proposed rezoning may ask questions or make their views known.

The hearing will be held in the Council Chambers, County Office, 1.6 kilometres west of Wetaskiwin on Highway 13, at 11:30 a.m. on Thursday, December 10, 2015.

Written submissions will be accepted up to the time of the hearing and should be addressed to the undersigned at the County Office.

ROD HAWKEN
 Assistant County Administrator
 County of Wetaskiwin No. 10

SNOWPLOWING PROGRAM

The County of Wetaskiwin is offering residents the option to purchase prepaid snowplowing flags exclusively for plowing of private driveways from the County roadway to allow the ratepayer access to their place of residence.

These flags may be purchased at the County Office or other locations designated by the County administration at a cost of \$50.00 per flag, including GST, which is valid for one use only.

The flag must be posted at the driveway indicating a request for snowplowing. The flag will be collected by the Patrol Operator when the driveway is plowed. Residents who reside within a Hamlet, within the corporate municipal boundaries of the County of Wetaskiwin No. 10 are not included in this policy.

NOTE: Snowplowing of driveways will only take place when all County roads have been plowed first.

NOTICE OF PUBLIC HEARING

TAKE NOTICE that the Council of the County of Wetaskiwin No. 10 has been asked to adopt an Area Structure Plan for Viewland Industrial Park, the subdivision and development of 20 industrial and commercial lots on the following land which is at the intersection of Highway 2 and Highway 616, five miles west of Millet and 16 miles south of Nisku, as shown on the accompanying map.



SW 33-47-25-W4M

Before considering the adoption of the Area Structure Plan, Council will hold a public hearing at which any person claiming to be affected by the proposed Area Structure Plan may ask questions or make their views known.

The hearing will be held in the Council Chambers, County Office, 1.6 kilometres west of Wetaskiwin on Highway 13, at 11:00 a.m., Thursday, December 10, 2015.

Written submissions will be accepted up to the time of the hearing and should be addressed to the undersigned at the County Office.

A copy of the proposed Plan may be purchased at the County of Wetaskiwin Administration Building or by contacting the Planning and Economic Development Department at (780) 352-3321.

ROD HAWKEN
 Assistant County Administrator
 County of Wetaskiwin No. 10



Notice to County of Wetaskiwin No. 10 Residents

Solid Waste Transfer Station Closures 2015 Holiday Season

Please be advised that the Solid Waste Transfer Stations located throughout the County will be closed on the following dates:

- Thursday, December 24, 2015 All Sites Closed (including Millet Transfer Station)
- Friday, December 25, 2015 All Site Closed
- Saturday, December 26, 2015 All Sites Closed
- Monday, December 28, 2015 All Sites Closed – **Except Lakedell Transfer Station - Open 9 a.m. to 5 p.m.**
- Friday, January 1, 2016 All Closed

PLOWING SNOW ONTO COUNTY ROADS

Please be advised that plowing snow from your yard into the County right of ways is not permitted. Concerns such as liability, safety and equipment damage are factors. Plowing snow into the ditches or side of road puts County employees and the safety of the traveling public at risk.

In accordance with the Public Highway Development Act, Section 43(1):

A person who, without justification or excuse, obstructs or deposits any material on a highway (as defined in the Act), or interferes with, breaks, cuts or otherwise injures a highway, is guilty of an offence.

Thank you for your cooperation in this matter.

Further inquiries may be addressed to Dave Dextraze, Director of Public Works at 780-361-6230 or Rod Hawken, Assistant CAO at 780-361-6225 or by contacting the County Administration Office at 780-352-3321 or 1-800-661-4125