



COUNTY OF WETASKIWIN NO.10

Strong Proactive Leadership • Safe Progressive Communities

Phone 780-352-3321 Toll Free 1 (800) 661-4125
www.county.wetaskiwin.ab.ca

OPPORTUNITY FOR EMPLOYMENT

COUNTY OF WETASKIWIN NO.10 – EAST END PART TIME HOME SUPPORT AIDES

The Position:

To assist seniors and disabled individuals with general homemaking duties so these people may remain in their homes.

The Person:

The successful candidate will require the following qualifications:

- Criminal Records Check
- Vulnerable Sectors Query
- Valid Drivers License
- Drivers Abstract
- Should have experience working with seniors, and have a healthy understanding of peoples needs.
- Must have own transportation, and be willing to work part-time hours.

Send resumes to :

Linda Goltz

Director of Family and Community Support Services

Email: lgoltz@county.wetaskiwin.ab.ca

Or by mail:

Box 114

Winfield AB TOC 2X0

Deadline for applications will remain open until a successful applicant is hired. Thank you for applying but only the persons being interviewed will be contacted.

NOTICE OF PUBLIC HEARING

Notice of proposed change in land use classification

TAKE NOTICE that the Council of the County of Wetaskiwin No. 10 has made an application to amend its Land Use By-Law by rezoning part of the following land, as shown on accompanying map, from Agricultural (AG) to Institutional (IS):

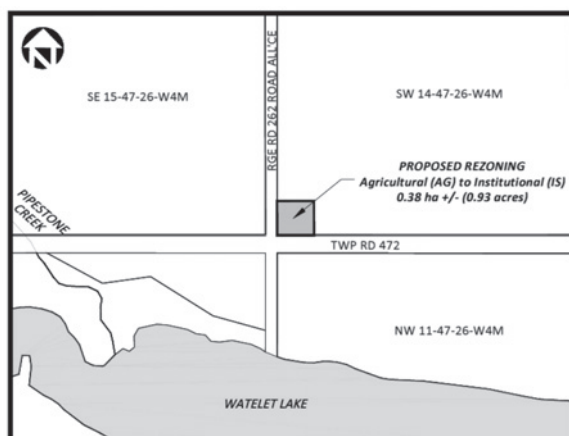

SW 14-47-26-W4M

The proposed rezoning will match the existing land use of the Grandview Cemetery. A copy of the Institutional District outlining permitted and discretionary uses can be obtained from the County Office.

Before proceeding further with the proposal, Council will hold a Public Hearing at which any person claiming to be affected by the proposed rezoning may ask questions or make their

views known. As per the Municipal Government Act, any person affected, has the right to petition this proposal.

The hearing will be held in the Council Chambers, County Office, 2.4 kilometres west of Wetaskiwin on Highway 13, at 10:30 a.m., Thursday, December 14, 2017.

Written submissions will be accepted up to the time of the hearing and should be addressed to the undersigned at the County Office.

DAVID BLADES, A. Sc. T., LGA

Director of Planning & Economic Development

County of Wetaskiwin No. 10

DEVELOPMENT PERMITS

TAKE NOTICE THAT THE FOLLOWING DEVELOPMENT PERMIT(S) FOR THE PROPOSED USE LISTED BELOW HAVE BEEN ISSUED IN ACCORDANCE WITH BY-LAW 95/54, LAND USE BY-LAW OF THE COUNTY OF WETASKIWIN NO. 10.

Development Permit # D17/263

EXISTING 22' X 24' GARAGE: SE-27-47-28-W4M, Plan 9020306, Lot 2. This is a discretionary use as specified by Section 9.1(b) of Schedule B Land Use By-law 94/54, amended by By-Law 15/10.

Development Permit # D17/268

40' x 10' RV USE: SW-25-45-1-W5M, Plan 1424259, Block 4, Lot 6. This is a discretionary use as specified by Section 9.3(d) and 9.5(b) of Schedule B Land Use By-law 94/54, amended by By-Law 15/10.

Development Permit # D17/269

EXISTING DWELLING, DETACHED GARAGE WITH ATTACHED SHED, 2.50' X 4.77' SHED, 3.73' X 2.50' SHED: NW-2-46-24-W4M, Plan 5304HW, Lot B. This is a discretionary use as specified by Section 2.8(b) of Schedule B AND 9.1(f) of Schedule A Land Use By-law 94/54, amended by By-Law 15/10.

THE ABOVE NOTED PERMIT(S) SHALL NOT COME INTO EFFECT UNTIL AFTER FOURTEEN (14) DAYS FROM THE FIRST DATE OF THIS PUBLICATION.

Any person wishing to review the above application(s) or permit(s) may do so at the County Office during normal business hours.

IN ACCORDANCE WITH SECTION 686 OF THE MUNICIPAL GOVERNMENT ACT, ANY PERSONS CLAIMING TO BE AFFECTED BY THIS DECISION MAY SERVE WRITTEN NOTICE OF APPEAL, ALONG WITH PRESCRIBED FEE OF \$150.00 TO:

FRANK COUTNEY, SECRETARY TO THE DEVELOPMENT APPEAL BOARD
COUNTY OF WETASKIWIN NO. 10
P.O. BOX 6960
WETASKIWIN, ALBERTA T9A 2G5

WITHIN FOURTEEN DAYS OF THE FIRST DATE OF THIS NOTICE.

NOTICE TO COUNTY RESIDENTS

The next Agricultural Service Board meeting will held at 9:00 a.m. at the County Administration Building, located 1½ miles west of Wetaskiwin on Highway 13, as follows:

MEETING	DATE
Agricultural Service Board	December 13, 2017

Pursuant to Section 196(2) of the Municipal Government Act, Chapter M-26, 2000, Council Committee meeting dates will be posted in the foyer of the County Administration Building.

NOTICE TO RATEPAYERS

RE: TAX ARREARS

Please be advised that current year's taxes are due December 31st, 2017. All outstanding taxes on January 1st, 2018 will be subject to a penalty of 7%, as per By-Law Number 2002/40.

Tax payments received by mail **MUST BE POSTMARKED** no later than December 31st, 2017. If the postmark indicates January 1st, 2018, the penalty will be applied. Should you wish to drop off your tax payment on or before December 31st, 2017, a mail slot is located at the front door of the County office for your convenience.

The County of Wetaskiwin No. 10 Administration Office will be closed on:

December 25th, 26th & 27th, 2017

& January 1st, 2018